

# Bonito Bebé

## TOSCANA COTBED



**IMPORTANT - RETAIN FOR FUTURE REFERENCE. READ CAREFULLY.**

***WARNING : DO NOT LEAVE YOUR CHILD UNATTENDED -  
YOUR CHILD'S SAFETY IS YOUR RESPONSIBILITY***

***[www.glasgowpramcentre.co.uk](http://www.glasgowpramcentre.co.uk)***

## Glasgow Pram Centre

25 – 29 McFarlane Street  
Glasgow  
G4 0TL

p - 0141 552 3998

f - 0141 552 4423

e - [sales@glasgowpramcentre.co.uk](mailto:sales@glasgowpramcentre.co.uk)

[www.glasgowpramcentre.co.uk](http://www.glasgowpramcentre.co.uk)

## **THESE INSTRUCTIONS ARE IMPORTANT - PLEASE READ CAREFULLY**

We strongly suggest you spent a short time reading through this leaflet and then follow the simple step by step guide to assembly.

**WARNING :** Do not leave your child unattended.

The correct use and maintenance of your cot-bed will ensure it gives long and trouble free use. Remember the safety of the child is your responsibility.

### **MATERIAL**

Your cot-bed is made in ash and ash veneer. Ash is a totally natural material therefore no two pieces are ever identical in pattern or colour. As ash furniture gets older its colour may change due to being exposed to light and air, so any new pieces may look a shade different to those you already have. Don't be concerned about this, as the colour difference will diminish over a small period of time.

Every piece has its unique appearance.

To keep the natural aspect, the surfaces were painted with a protection varnish. The beauty of your furniture can be kept, cleaning it with a soft dust absorbing tissue. Occasionally a water-humidified tissue can be used and in this case, don't forget to clean it again with a dry one.

All furniture can be damaged by knocks and scrapes – if you dent the surface or break the seal of the lacquer, rub some solid wax into the dent to exclude the atmospheric moisture.

### **ASSEMBLY**

Before starting the assembly, please read through these instructions. Then carefully unpack your cot-bed and check that you have a complete set of parts against the list.

We recommend that you assemble your cot-bed on a clean, flat surface, making sure there are no sharp objects present that may mark or damage the panels.

When gluing, use small amount of glue on the dowels and not in the dowel holes. Wipe away any excess immediately with a clean damp cloth

### **CAUTION**

There are many small components used in the construction of this cot-bed. These items should be kept out of reach of young children whilst assembling the unit.

### **INSTRUCTIONS FOR SAFE USE**

- Place your cot-bed on a stable surface
  - Regularly check all the fittings to make sure they are tight and that the chest is not damaged
- Do not place your cot-bed in the close proximity of an open fire and the sources of heat, such as radiators, electric or gas fires.
- There are several height positions for the base and the lowest position is the safest. Only use the lowest position when the child can sit or kneel.
  - Your cot-bed is suitable for a mattress of 1360-1400mm in length and 660-700 in width.
- The thickness of the mattress should be such that the distance between the top of the mattress and the top of the sides should be no less than 500mm when the base is in the lowest position, and 200mm when in the highest position. A label and a mark in the wood will indicate this.
- Do not leave anything in the cot-bed, which could provide a foothold or present a danger of suffocation or strangulation.

## Glasgow Pram Centre

25 – 29 McFarlane Street  
Glasgow  
G4 0TL

p - 0141 552 3998

f - 0141 552 4423

e - [sales@glasgowpramcentre.co.uk](mailto:sales@glasgowpramcentre.co.uk)

[www.glasgowpramcentre.co.uk](http://www.glasgowpramcentre.co.uk)

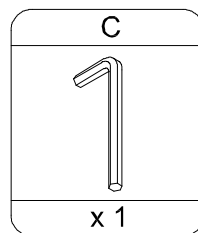
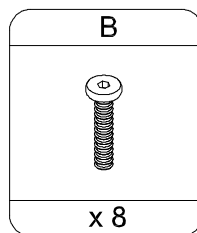
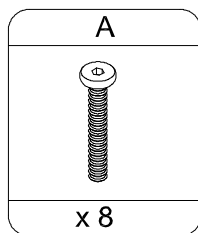
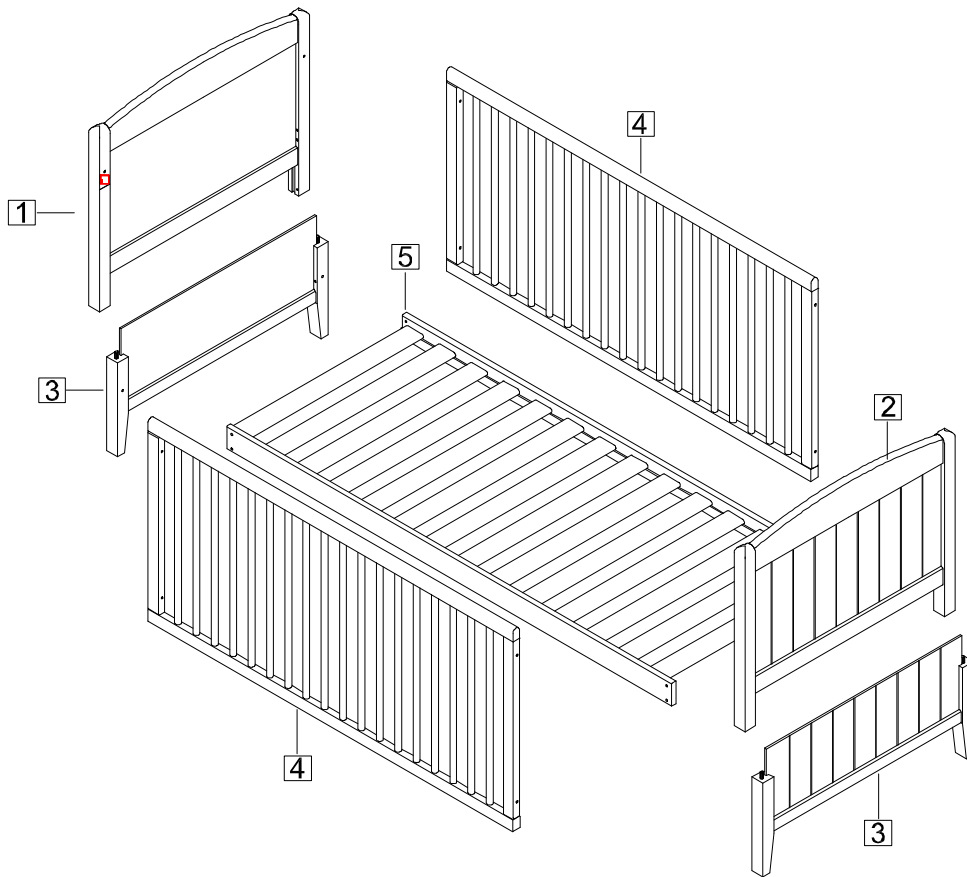

1.

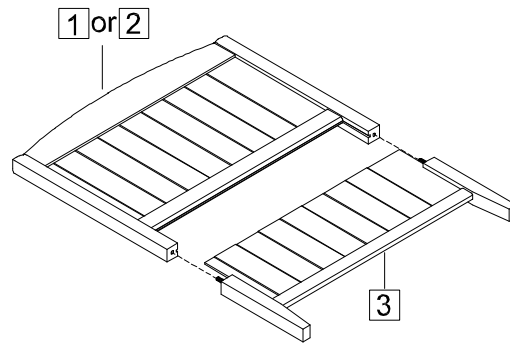

2. Do not fully tighten screws until the assembly is complete

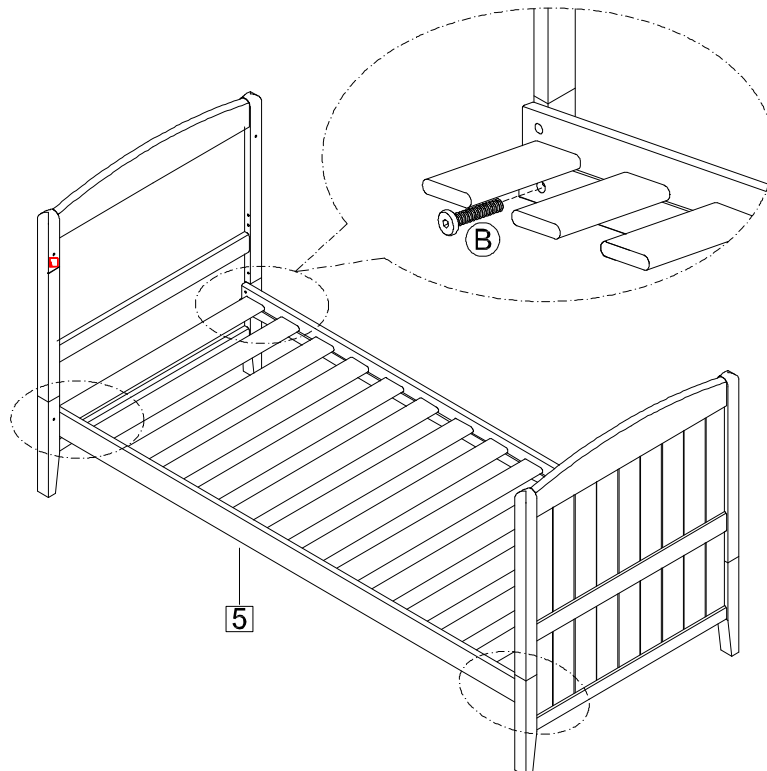

3. Finally, tighten all screws with the Allen key provided.

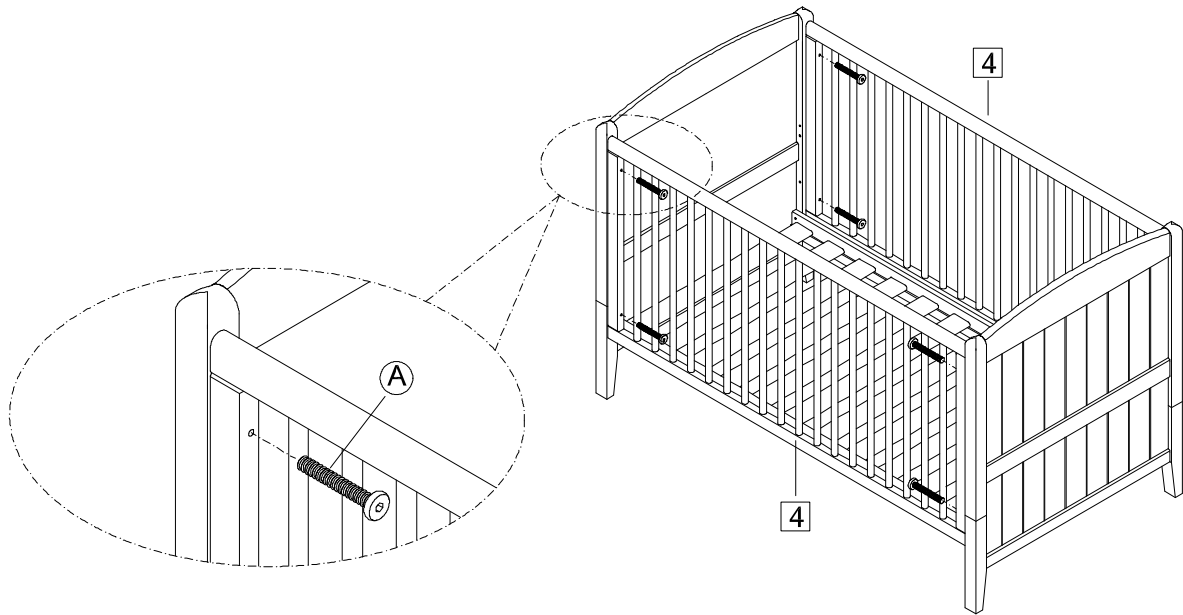

4.

